

---

---

---

**GARDNER DENVER®**

301FWQ997 Rev A  
SEPTEMBER 2011

**WELL SERVICING PUMP**

**MODEL**

**GD-1000Q**

**FLUID END  
PARTS LIST**

**Gardner**  

---

**Denver**

ECN 1057977

# GD-1000Q WELL SERVICING PUMP FLUID END PARTS LIST

## MAINTAIN PUMP RELIABILITY AND PERFORMANCE WITH GENUINE GARDNER DENVER PARTS AND SUPPORT SERVICES

Gardner Denver® genuine pump parts, manufactured to design tolerances, are developed for optimum dependability. Design and material innovations are the result of years of experience with hundreds of different pump applications. Reliability in materials and quality assurance are incorporated in our genuine replacement parts.

Gardner Denver supports your needs with these services:

1. Trained parts specialists to assist you in selecting the correct replacement parts.
2. Repair and maintenance kits designed with the necessary parts to simplify servicing your pump.

Authorized service technicians are factory trained and skilled in pump maintenance and repair. They are ready to respond and assist you by providing fast, expert maintenance and repair services.

**For the location of your local authorized Gardner Denver distributor refer to the yellow pages of your directory or contact:**

<b>Factory (Tulsa):</b>	<b>Service Center (Odessa):</b>	<b>Service Center (Ft. Worth)</b>
Gardner Denver Well Servicing Pumps 4747 South 83 <sup>rd</sup> East Avenue Tulsa, Oklahoma 74145	Chaparral 2121 West 44 <sup>th</sup> Street Odessa, Texas 79768	Geoquip 7533 Kathy Lane Ft. Worth, Texas 76126
Phone:     (918) 664-1151 (800) 637-8099	Phone:     (432) 366-5433 (800) 368-1134	Phone:     (817) 249-6400 (800) 824-0271
Fax:         (918) 664-6225	Fax:         (432) 363-9940	Fax         (817) 249-6401

### INSTRUCTION FOR ORDERING REPAIR PARTS

When ordering parts, specify Pump MODEL and SERIAL NUMBER (see nameplate on unit). The Serial Number is also stamped on top of the cylinder end of the frame (cradle area).

Where NOT specified, quantity for parts required per pump unit is one (1); where more than one is required per unit, quantity is indicated in parenthesis.

**SPECIFY THE NUMBER OF PARTS REQUIRED.**

**DO NOT ORDER BY SETS OR GROUPS.**

To determine the Right Hand and Left Hand side of a pump, stand at the power end and look toward the fluid end. Right Hand and Left Hand are indicated in parenthesis following the part name, i.e. (RH) & (LH), when appropriate

# GARDNER DENVER PRODUCT WARRANTY

## GENERAL PROVISIONS AND LIMITATIONS

Gardner Denver (the "Company") warrants to each original retail purchaser ("Purchaser") of its new products, assemblies or parts from the Company or its authorized distributors that such products are, at the time of delivery to the Purchaser, made with good material and workmanship. No warranty is made with respect to:

1. Any product which has been repaired or altered in such a way, in the Company's judgment, as to affect the product adversely.
  2. Any product which has, in the Company's judgment, been subject to negligence, accident, or improper storage, improper installation, operation or application. (Examples: over-pressure, sand-outs, cavitation, corrosion, erosion or degradation).
  3. Any product which has not been operated or maintained in accordance with the recommendations of the Company.
  4. Components or accessories manufactured, warranted and serviced by others.
- Any reconditioned or prior owned product.

Claims for items described in (4) above should be submitted directly to the manufacturer.

## WARRANTY PERIOD

The Company's obligation under this warranty is limited to repairing or, at its option, replacing, during normal business hours at an authorized service facility of the Company, any part or assembly which in the Company's judgment proved to have unsatisfactory material or workmanship within the applicable Warranty Period as follows.

Except for the products or components listed below, and subject to the limitations and restrictions set forth in the "Disclaimer" section set forth below, the Warranty Period for all products is 1,250 hours of operation or three (3) months after start-up, not to exceed 120 days after delivery to Purchaser, whichever occurs first. The exceptions are as follows:

1. Power end is warranted for twelve (12) months from date of start-up or eighteen (18) months from date of delivery to the Purchaser, whichever occurs first.
2. Forged steel fluid cylinders are warranted for materials and workmanship for 6 months from the date of installation or 18 months from the date of delivery to the purchaser, which ever occurs first.

3. Repairs are warranted for 90 days from the date of delivery, for the workmanship and materials of the new parts installed.
4. Weld repaired fluid ends and weld repaired components are not warranted.
5. Expendable fluid end parts, including, but not limited to, valves, valve parts, packing, liners and pistons, are not covered by this warranty due to variable abrasive nature of material pumped.

## PRESERVATION ASSEMBLIES DESTINED FOR STORAGE

In order for warranty acceptance any pump assembly not immediately installed or destined to be in storage or in transit for extended periods of time must be prepared for storage as defined in the Company's Long Term Storage Procedure. This includes but is not limited to:

- Drain and thoroughly clean inside power end crankcase.
- Spray rust inhibiting oil on all bearing, machined and inside surfaces of the power end.
- Induce clean gear oil into any circulating pump, filter, heat exchanger and piping.
- Remove valves, seats and plungers from the fluid end. Thoroughly clean and dry these parts and all internal surfaces. Coat all cylinder bores, valve covers and reusable expendable parts with rust preventative.
- Flush all water, and contaminants from pump, tanks, hoses and spray nozzles. Spray all components with a rust inhibiting oil.
- Rotate pump every 30 days to insure bearings are oiled.
- At the expense of the Purchaser, any product properly preserved must be inspected by an authorized agent of the Company, prior to the Company, granting any extended warranty beyond that stated in this warranty.

## LABOR TRANSPORTATION AND INSPECTION

The Company will provide labor, by Company representative or authorized service personnel, for repair or replacement of any product or part thereof which in the Company's judgment is proved not to be as warranted. Labor shall be limited to the amount

specified in the Company's labor rate schedule. Labor costs in excess of the Company rate schedules caused by, but not limited to, location or inaccessibility of the equipment, or labor provided by unauthorized service personnel is not provided for by this warranty.

All costs of transportation of product or parts claimed not to be as warranted and, of repaired or replacement parts to or from such service facility shall be borne by the Purchaser. The Company may require the return of any part claimed not to be as warranted to one of its facilities as designated by the Company, transportation prepaid by the Purchaser, to establish a claim under this warranty.

Replacement parts provided under the terms of this warranty are warranted for the remainder of the Warranty Period of the product upon which installed to the same extent as if such parts were original components.

The Company may request a root cause analysis be performed in-order to identify if a request for warranty claim meets the requirements of this warranty.

### **DISCLAIMER**

Except as to title, the foregoing warranty is the sole and exclusive warranty of the Company. The Company hereby extends other manufactures' warranty or guaranties, if any given to Company by such manufacturer, but only to the extent the Company is able to enforce such warranty or guaranties. The Company has not authorized any party to make any representation or warranty other than as expressly set forth herein. SELLER HEREBY DISCLAIMS AND EXCLUDES ANY OTHER EXPRESS, IMPLIED OR STATUTORY WARRANTIES, ARISING BY OPERATION OF LAW OR OTHERWISE, INCLUDING, WITHOUT LIMITATION, ANY WARRANTIES OF MERCHANTABILITY OR FITNESS FOR A PARTICULAR PURPOSE. COMPANY MAKES NO WARRANTIES OR REPRESENTATIONS OF ANY KIND WHATSOEVER (EXPRESS, IMPLIED OR STATUTORY), OF LAW OR OTHERWISE, ON ANY EQUIPMENT, COMPONENT PARTS OR ACCESSORIES SOLD HEREUNDER WHICH, ARE NOT MANUFACTURED BY COMPANY.

NOTWITHSTANDING ANYTHING HEREIN TO THE CONTRARY, THE FOREGOING WARRANTY SHALL BE THE SOLE AND EXCLUSIVE REMEDY AVAILABLE TO THE PURCHASER. UNDER NO CIRCUMSTANCES, WHETHER IN CONTRACT, TORT OR OTHERWISE, SHALL THE COMPANY'S TOTAL LIABILITY ARISING IN CONNECTION WITH ANY PURCHASE ORDER EXCEED THE AMOUNT OF ANY SALES OR OTHER PROCEEDS RECEIVED PURSUANT THERETO. IN ADDITION, UNDER NO CIRCUMSTANCES, WHETHER IN CONTRACT, TORT OR OTHERWISE, SHALL THE COMPANY BE LIABLE FOR LIQUIDATED, SPECIAL, INDIRECT, INCIDENTAL, EXEMPLARY, OR CONSEQUENTIAL DAMAGES, EXPENSES OR COSTS, INCLUDING, WITHOUT LIMITATION, LOST PROFITS OR FACILITY DOWNTIME, HOWEVER CAUSED AND EVEN IF THE POTENTIAL OF SUCH DAMAGES WAS DISCLOSED AND/OR KNOWN.

No statement, representation, agreement, or understanding, oral or written, made by any agent, distributor, representative, or employee of the Company which is not contained in this Warranty will be binding upon the Company unless made in writing and executed by an officer of the Company.

This warranty shall not be effective as to any claim which is not presented within 30 days after the date upon which the product is claimed not to have been as warranted. Any action for breach of this warranty must be commenced within one year after the date upon which the cause of action occurred.

Any adjustment made pursuant to this warranty shall not be construed as an admission by the Company that any product was not as warranted.

### **WARRANTY REQUESTS**

Products to be returned for warranty analysis shall be approved for return in writing by the Company prior to shipment. All requests for product return shall be submitted by email. Facsimile or letter to:

Warranty Department c/o  
Gardner Denver Petroleum Pumps  
4747 South 83<sup>rd</sup> East Avenue  
Tulsa, Oklahoma 74145

Email: [CCR.QAR@gardnerdenver.com](mailto:CCR.QAR@gardnerdenver.com)  
Facsimile:(918)664-

## TABLE OF CONTENTS

MAINTAIN PUMP RELIABILITY AND PERFORMANCE.....	i
GARDNER DENVER PRODUCT WARRANTY .....	ii
SPECIAL NOTICE CONCERNING PART COMPATIBILITY .....	1
FLUID END ASSEMBLY 2.75" - 3".....	2
FLUID END ASSEMBLY 3.5" - 4.5".....	5
HOUSING GROUP .....	8
NON ADJUSTABLE HNBR CDI PACKING.....	9
RUBBER SPRING LOADED PACKING.....	10
NON ADJUSTABLE HNBR CDI PACKING.....	11
VALVE GROUP .....	12
PLUNGER GROUP .....	13
DISCHARGE FLANGE GROUP.....	14
DISCHARGE FLANGE GROUP (BLIND) .....	15
SUCTION MANIFOLD GROUP.....	16
VALVE SEAT PULLER KITS.....	17

## TABLE OF FIGURES

Figure 1: FLUID END ASSEMBLY 2.75" - 3" ISO VIEW.....	2
Figure 2: FLUID END ASSEMBLY 2.75" - 3" FRONT VIEW .....	2
Figure 3: FLUID END ASSEMBLY 2.75" - 3" SECTION A-A.....	3
Figure 4: FLUID END ASSEMBLY ISO VIEW 3.5" - 4.5" .....	5
Figure 5: FLUID END ASSEMBLY 3.5" - 4.5" FRONT VIEW .....	5
Figure 6: FLUID END ASSEMBLY 3.5" - 4.5" SECTION A-A.....	6
Figure 7: HOUSING GROUP 3" .....	8
Figure 8: HOUSING GROUP 3.5" .....	8
Figure 9: CDI PACKING 3" .....	9
Figure 10: RSL PACKING 3.5" .....	10
Figure 11: CDI PACKING 3.5" .....	11
Figure 12: VALVE GROUP 2.5" - 3" .....	12
Figure 13: VALVE GROUP 3.5" - 4.5" .....	12
Figure 14: PLUNGER GROUP 3".....	13
Figure 15: PLUNGER GROUP 3.5".....	13
Figure 16: DISCHARGE FLANGE GROUP .....	14
Figure 17: DISCHARGE FLANGE GROUP (BLIND) .....	15
Figure 18: SUCTION MANIFOLD GROUP .....	16

## **SPECIAL NOTICE CONCERNING PART COMPATIBILITY**

THIS PARTS LIST CONTAINS PART NUMBERS THAT ARE COMPATIBLE WITH THE GARDNER DENVER GD-1000Q FLUID CYLINDER. THE PART NUMBERS LISTED MAY NOT BE COMPATIBLE WITH OTHER FLUID ENDS AVAILABLE FOR THE GD-1000Q PUMP MODELS. ALL PART NUMBERS IN THIS MANUAL ARE COMPATIBLE WITH THE FOLLOWING BARE FLUID CYLINDER PART NUMBERS:

<b>Part No.</b>	<b>Part Name</b>
PP1073404	CYLINDER-FLUID 2.75" - 3" GD-1000Q
PP1077331	CYLINDER-FLUID 3.5" - 4.5" GD-1000Q

BEFORE ORDERING, VERIFY THAT YOUR BARE FLUID CYLINDER PART NUMBER MATCHES ONE OF THE BARE FLUID CYLINDER PART NUMBERS LISTED ABOVE.

# FLUID END ASSEMBLY 2.75" - 3"

Order by part number and description. Reference numbers are for your convenience only.

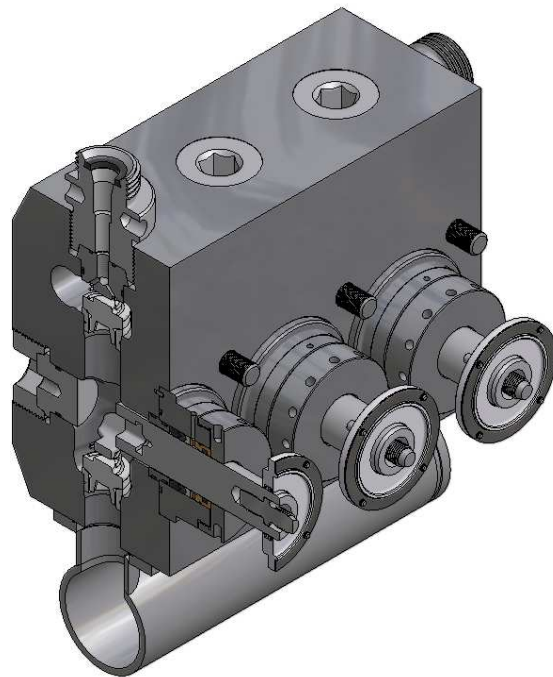

Ref. Drawing  
304FWQ810

Figure 1: FLUID END ASSEMBLY 2.75" - 3" ISO VIEW

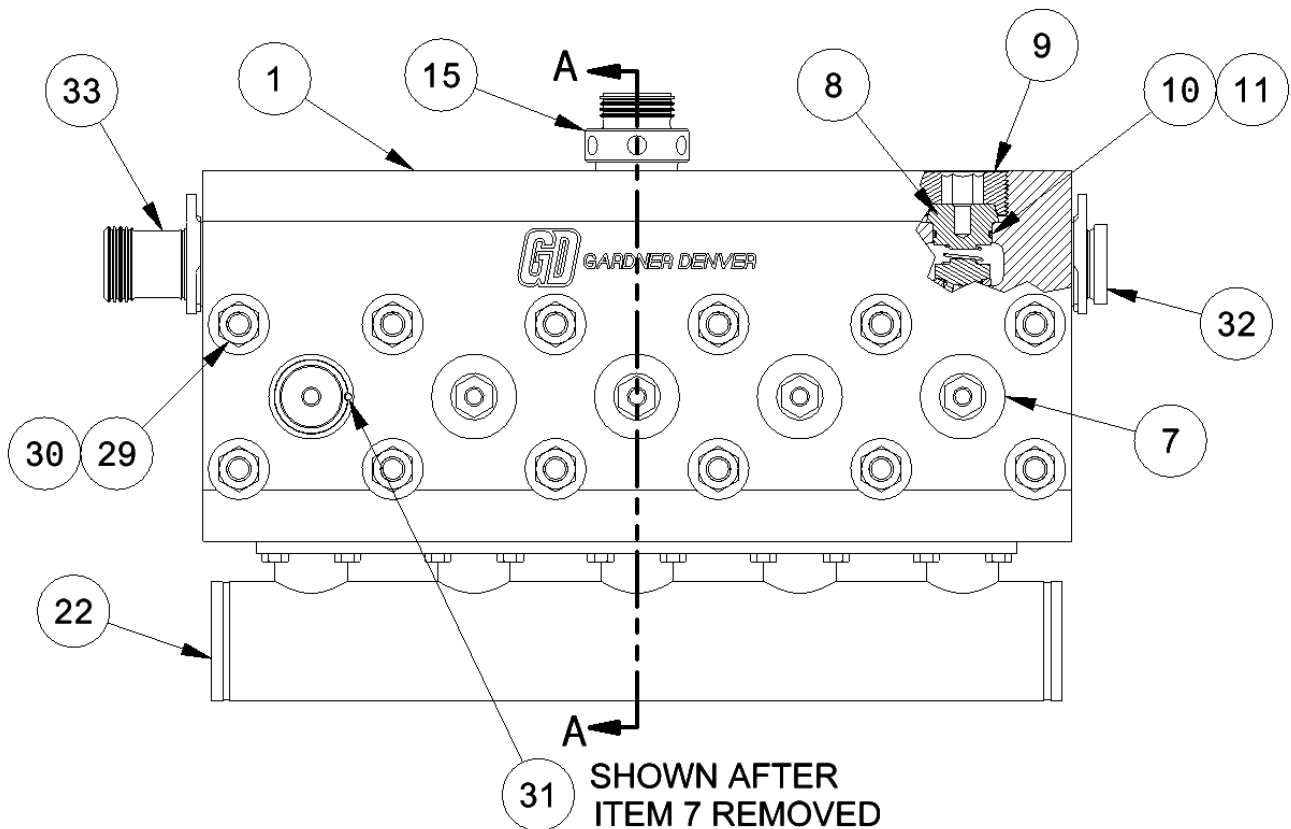
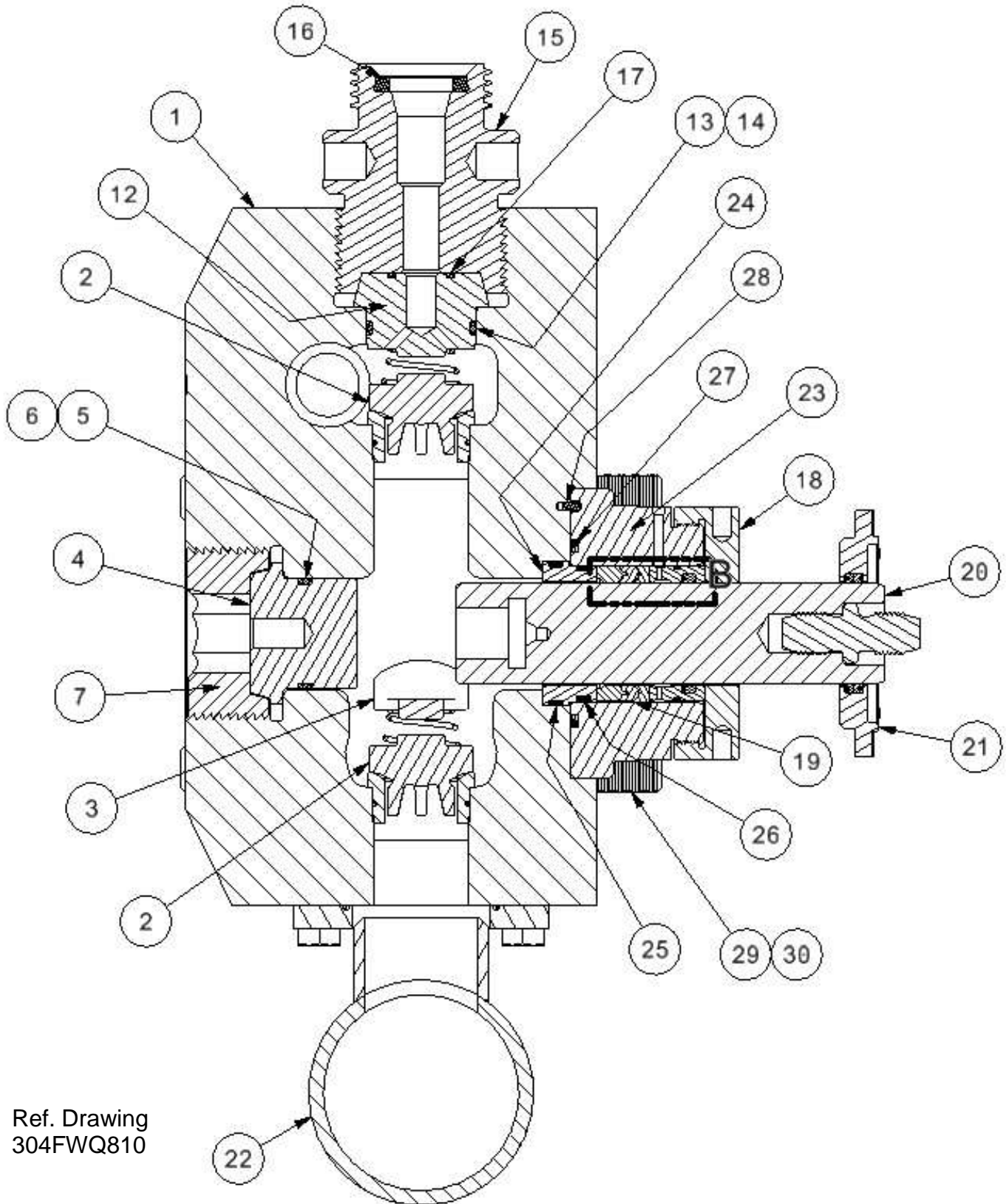

Figure 2: FLUID END ASSEMBLY 2.75" - 3" FRONT VIEW



### FLUID END ASSEMBLY 2.75" - 3"

Order by part number and description. Reference numbers are for your convenience only.



Ref. Drawing  
304FWQ810

Figure 3: FLUID END ASSEMBLY 2.75" - 3" SECTION A-A

### FLUID END ASSEMBLY 3"

Order by part number and description. Reference numbers are for your convenience only.

Ref. No.	Name of Part	Qty.	Part No.
1	FLUID CYLINDER 2.75" - 3" (GD-1000Q)	1	PP1073404
2	VALVE GROUP	10	See Page 12
3	SPRING RETAINER	5	PP1045233
4	VALVE COVER	5	PP1080779
5	O-RING	5	107975
6	BACKUP RING	10	25BC651
7	RETAINER	5	303WPD205
8	VALVE COVER (BLIND)	4	314WPD147
9	RETAINER	4	303WPD205
10	O-RING	4	107975
11	BACKUP RING	8	25BC651
12	VALVE COVER (GAGE CONNECTION)	1	315WPD147
13	O-RING	1	107975
14	BACKUP RING	2	25BC651
15	RETAINER	1	304WPD205
16	SEAL	1	901SH06-1
17	O-RING	1	107967
18	GLAND	5	PP1047188
19	PACKING GROUP	5	See Page 9
20	PLUNGER GROUP	5	See Page 13
21	HOUSING GROUP	5	See Page 8
22	SUCTION MANIFOLD	1	See Page 16
23	STUFFING BOX	5	PP1074004
24	STUFFING BOX SLEEVE	5	PP1074010
25	SEAL	5	PP1074915
26	SEAL	5	PP1074011
27	O-RING	5	107986
28	DOWEL PIN	5	62M20
29	STUD	12	PP1036135
30	NUT	12	VP1036194
31	DOWEL PIN	5	62M48
32	DISCHARGE FLANGE GROUP (BLIND)	1	See Page 15
33	DISCHARGE FLANGE GROUP	1	See Page 14

### FLUID END ASSEMBLY 3.5" - 4.5"

Order by part number and description. Reference numbers are for your convenience only.

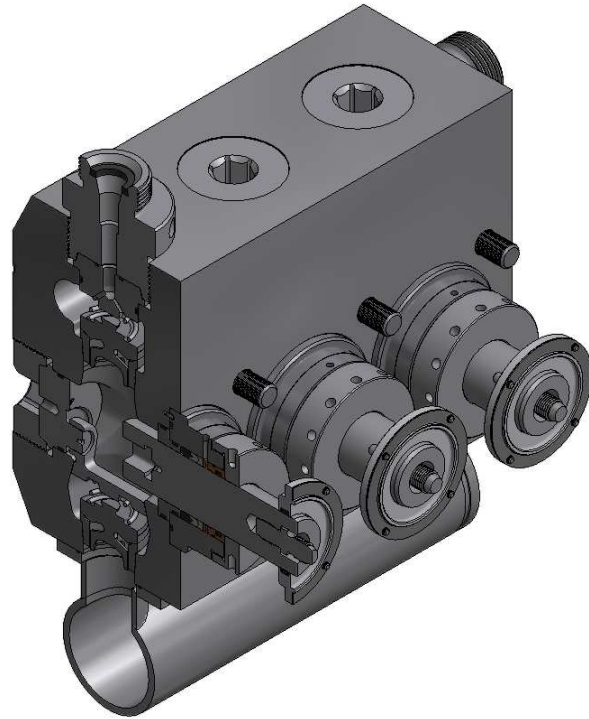

Ref. Drawing  
310FWQ810

Figure 4: FLUID END ASSEMBLY ISO VIEW 3.5" - 4.5"

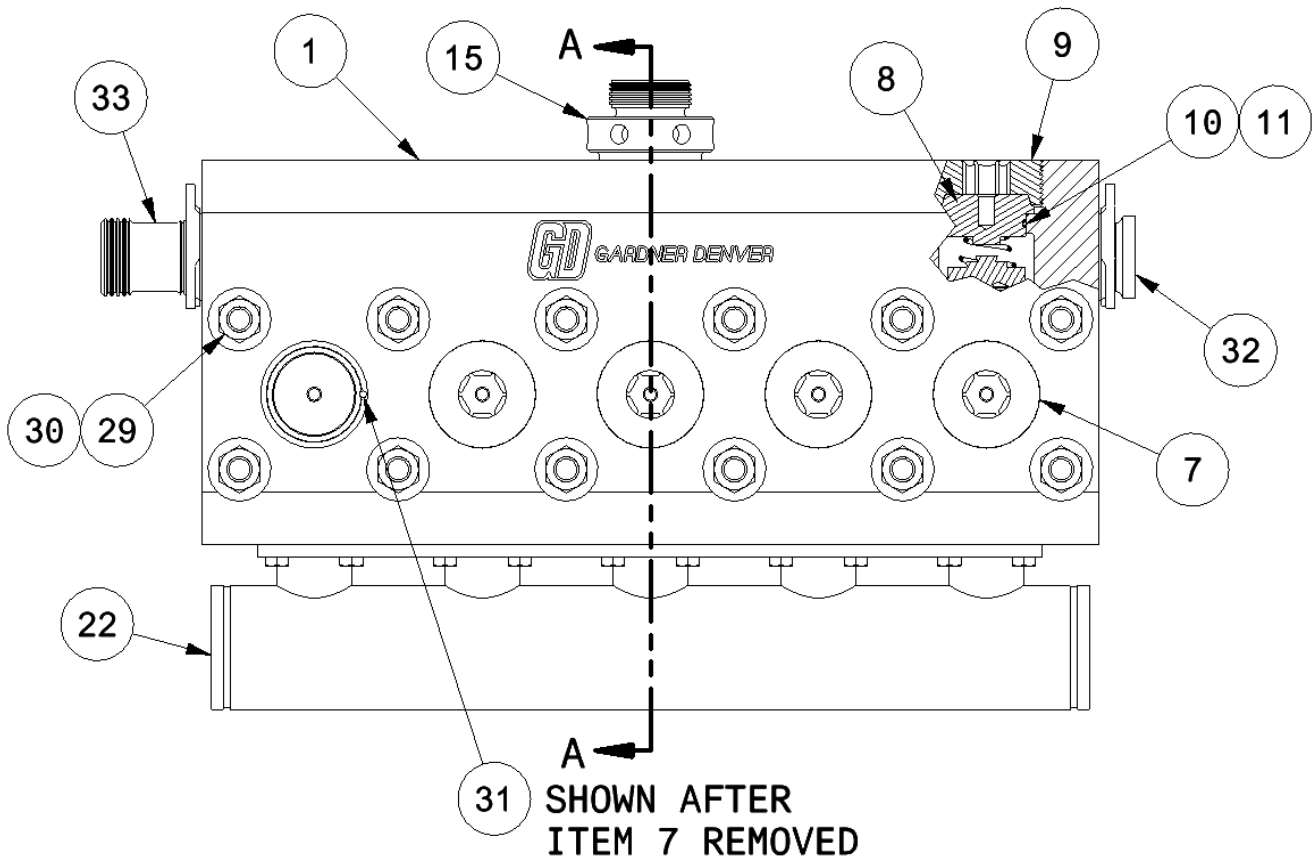
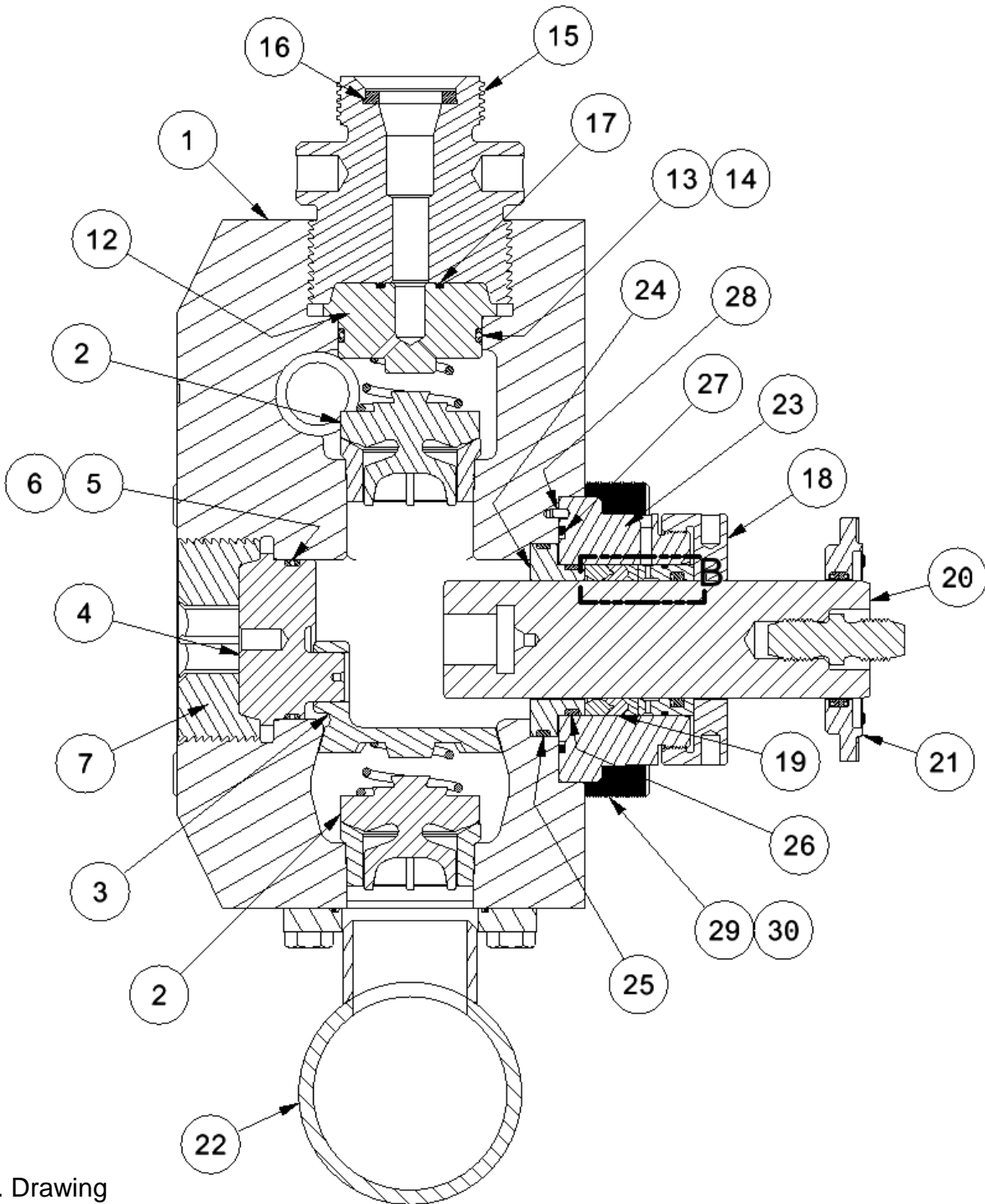

Figure 5: FLUID END ASSEMBLY 3.5" - 4.5" FRONT VIEW

### FLUID END ASSEMBLY 3.5" - 4.5"

Order by part number and description. Reference numbers are for your convenience only.



Ref. Drawing  
310FWQ810

Figure 6: FLUID END ASSEMBLY 3.5" - 4.5" SECTION A-A

## FLUID END ASSEMBLY 3.5"

Order by part number and description. Reference numbers are for your convenience only.

Ref No.	Name of Part	Qty.	Part No.
1	FLUID CYLINDER 3.5" - 4.5" (GD-1000Q)	1	PP1077331
2	VALVE GROUP	10	See Page 12
3	SPRING RETAINER	5	PP1030738
4	VALVE COVER	5	PP1047183
5	O-RING	5	185351
6	BACKUP RING	10	25BC653
7	RETAINER	5	305WPD205
8	VALVE COVER (BLIND)	4	PP1047179
9	RETAINER	4	305WPD205
10	O-RING	4	107981
11	BACKUP RING	8	25BC652
12	VALVE COVER (GAGE CONNECTION)	1	PP1047180
13	O-RING	1	107981
14	BACKUP RING	2	25BC652
15	RETAINER	1	PP1047182
16	SEAL	1	901SH06-1
17	O-RING	1	107967
18	GLAND	5	PP1077340
19	PACKING GROUP	5	See Page 10,11
20	PLUNGER GROUP	5	See Page 13
21	HOUSING GROUP	5	See Page 8
22	SUCTION MANIFOLD	1	See Page 16
23	STUFFING BOX	5	PP1077332
24	STUFFING BOX SLEEVE	5	PP1077333
25	SEAL	5	PP1077337
26	SEAL	5	PP1077338
27	O-RING	5	107991
28	DOWEL PIN	5	62M20
29	STUD	12	PP1036135
30	NUT	12	VP1036194
31	DOWEL PIN	5	62M48
32	DISCHARGE FLANGE GROUP (BLIND)	1	See Page 15
33	DISCHARGE FLANGE GROUP	1	See Page 14

## HOUSING GROUP

Order by part number and description. Reference numbers are for your convenience only.

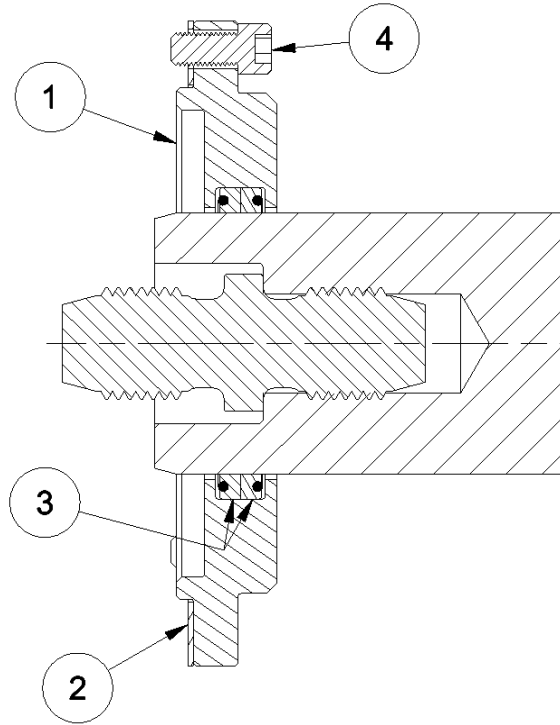

Ref. Drawing  
305FWQ810

**Figure 7: HOUSING GROUP 3"**

### HOUSING GROUP 3": 406FWB4044

Ref. No.	Name of Part	Qty.	Part No.
1	OIL STOP HEAD	1	PP1003833
2	GASKET	1	PP1028171
3	SEAL	2	60AM52
4	SCREW	4	75P6

**Figure 8: HOUSING GROUP 3.5"**

### HOUSING GROUP (NEW STYLE) 3.5": 407FWB4044

Ref. No.	Name of Part	Qty.	Part No.
1	OIL STOP HEAD	1	PP1003834
2	GASKET	1	PP1028171
3	SEAL	2	60AM54
4	SCREW	4	75P6

## NON ADJUSTABLE HNBR CDI PACKING

Order by part number and description. Reference numbers are for your convenience only.

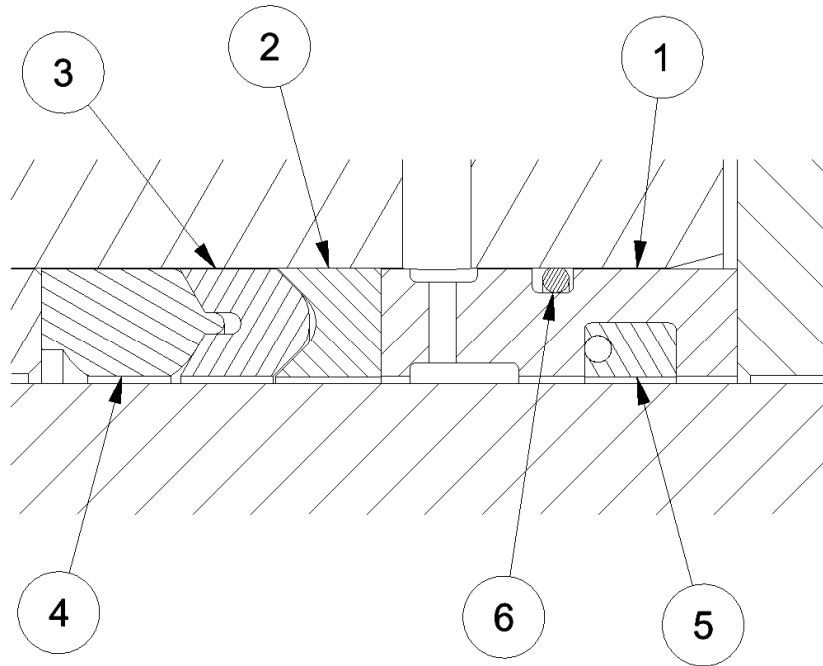

Ref. Drawing  
304FWQ810

**Figure 9: CDI PACKING 3"**

### PACKING GROUP 3": 301FWQ4060

Ref. No.	Name of Part	Qty.	Part No.
1	LANTERN SPACER	1	PP1035978
2	ADAPTER	1	595686000
3	PACKING RING	1	595694000
4	HEADER RING	1	595702000
5	SEAL	1	595710000
6	O-RING	1	901SH05-240

## RUBBER SPRING LOADED PACKING

Order by part number and description. Reference numbers are for your convenience only.

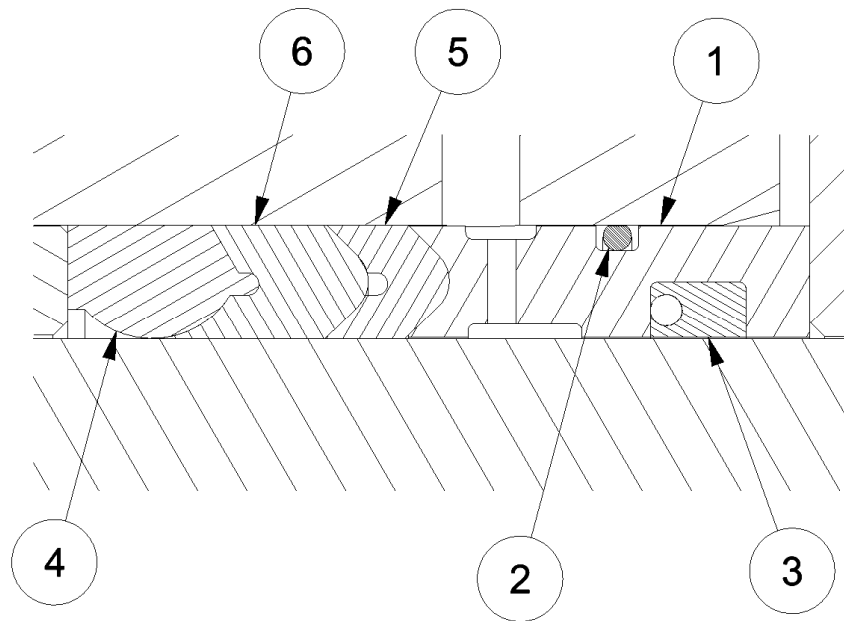

Ref. Drawing  
310FWQ810

**Figure 10: RSL PACKING 3.5"**

**PACKING GROUP 3.5": 303FWQ4060**

Ref. No.	Name of Part	Qty.	Part No.
1	LANTERN SPACER	1	PP1084164
2	O-RING	1	161125
3	SEAL	1	60AM83
4	HEADER RING	1	901VP014-012
5	PRESSURE RING	1	100972
6	PACKING RING	1	100297



### NON ADJUSTABLE HNBR CDI PACKING

Order by part number and description. Reference numbers are for your convenience only.

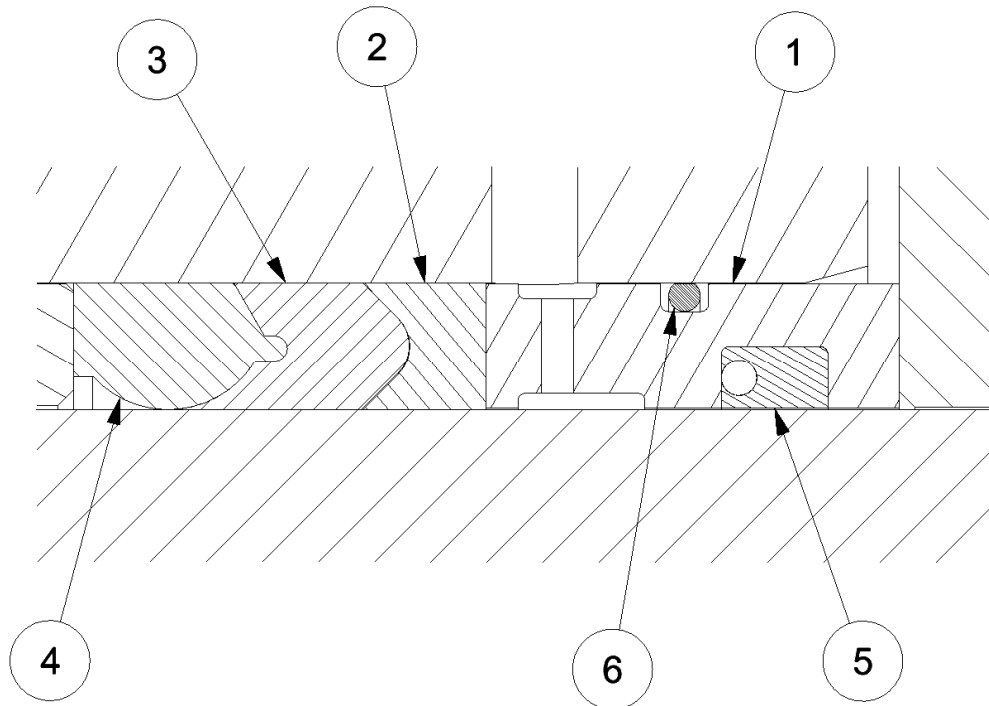

Ref. Drawing  
310FWQ810

**Figure 11: CDI PACKING 3.5"**

**PACKING GROUP 3.5": 302FWQ4060**

Ref. No.	Name of Part	Qty.	Part No.
1	LANTERN SPACER	1	PP1077750
2	ADAPTER	1	308OPE170
3	PACKING RING	1	309OPE222
4	HEADER RING	1	302OPE222
5	SEAL	1	60AM83
6	O-RING	1	161125

## VALVE GROUP

Order by part number and description. Reference numbers are for your convenience only.

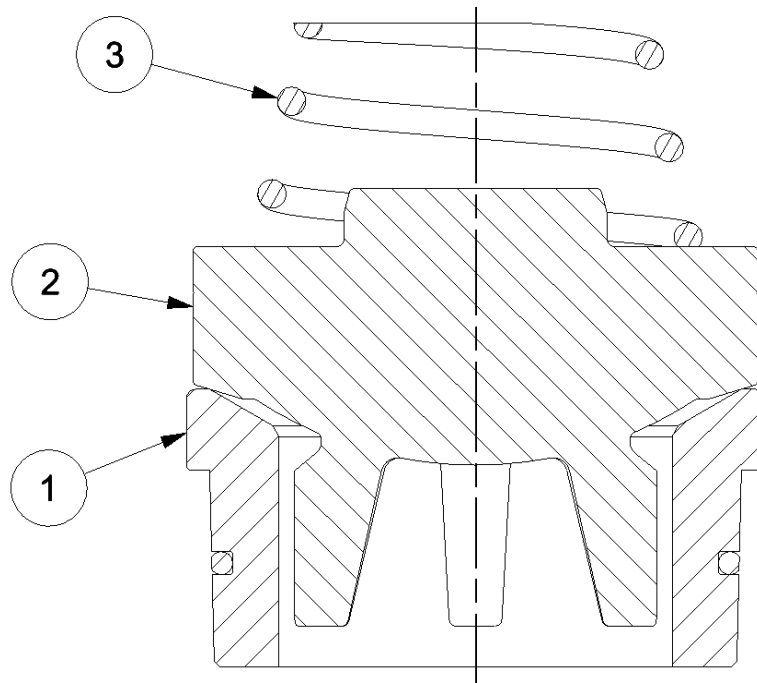

Ref. Drawing  
306FWQ810

**Figure 12: VALVE GROUP 2.5" - 3"**

**VALVE GROUP 2.5" - 3": 403WPD4030**

Ref. No.	Name of Part	Qty.	Part No.
1	VALVE SEAT	1	928SH01-8
2	VALVE	1	927SH01-7
3	SPRING	1	918VP024

**Figure 13: VALVE GROUP 3.5" - 4.5"**

**VALVE GROUP 3.5" - 4.5": 406WPD4030**

Ref. No.	Name of Part	Qty.	Part No.
1	VALVE SEAT	1	928SH01-4
2	VALVE	1	927VP010-003
3	SPRING	1	918VP023

## PLUNGER GROUP

Order by part number and description. Reference numbers are for your convenience only.

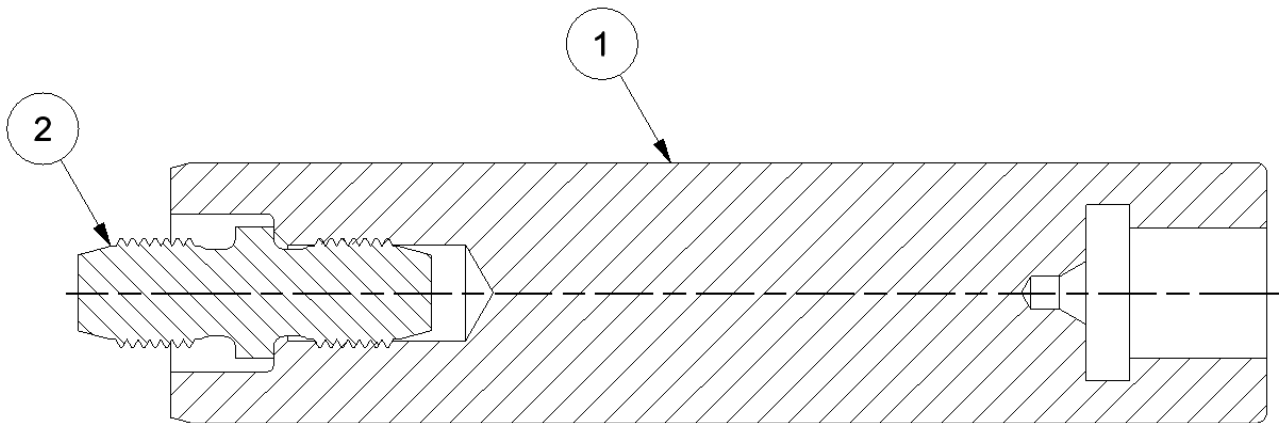

Ref. Drawing  
309FWQ810

**Figure 14: PLUNGER GROUP 3"**

**PLUNGER GROUP 3": 401FWB4066**

Ref. No.	Name of Part	Qty.	Part No.
1	PLUNGER	1	102414
2	STUD	1	PP1006122

**Figure 15: PLUNGER GROUP 3.5"**

**PLUNGER GROUP 3.5": 402FWB4066**

Ref. No.	Name of Part	Qty.	Part No.
1	PLUNGER	1	102413
2	STUD	1	PP1006122

## DISCHARGE FLANGE GROUP

Order by part number and description. Reference numbers are for your convenience only.

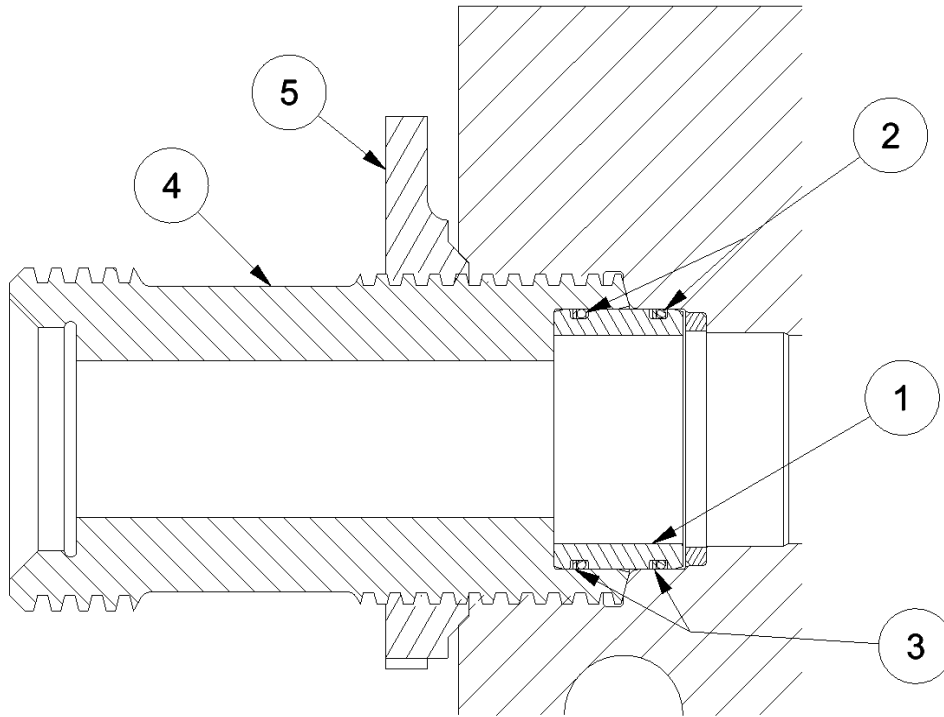

Ref. Drawing  
310FWQ810

**Figure 16: DISCHARGE FLANGE GROUP**

**2" 1502 15,000 PSI TREATING (STANDARD): 402TWC4038**

Ref. No.	Name of Part	Qty.	Part No.
1	BUSHING	1	403400090
2	O-RING	2	169828
3	BACK-UP RING	2	429003000
4	ADAPTER	1	479197090
5	WING NUT	1	403403000

## DISCHARGE FLANGE GROUP (BLIND)

Order by part number and description. Reference numbers are for your convenience only.

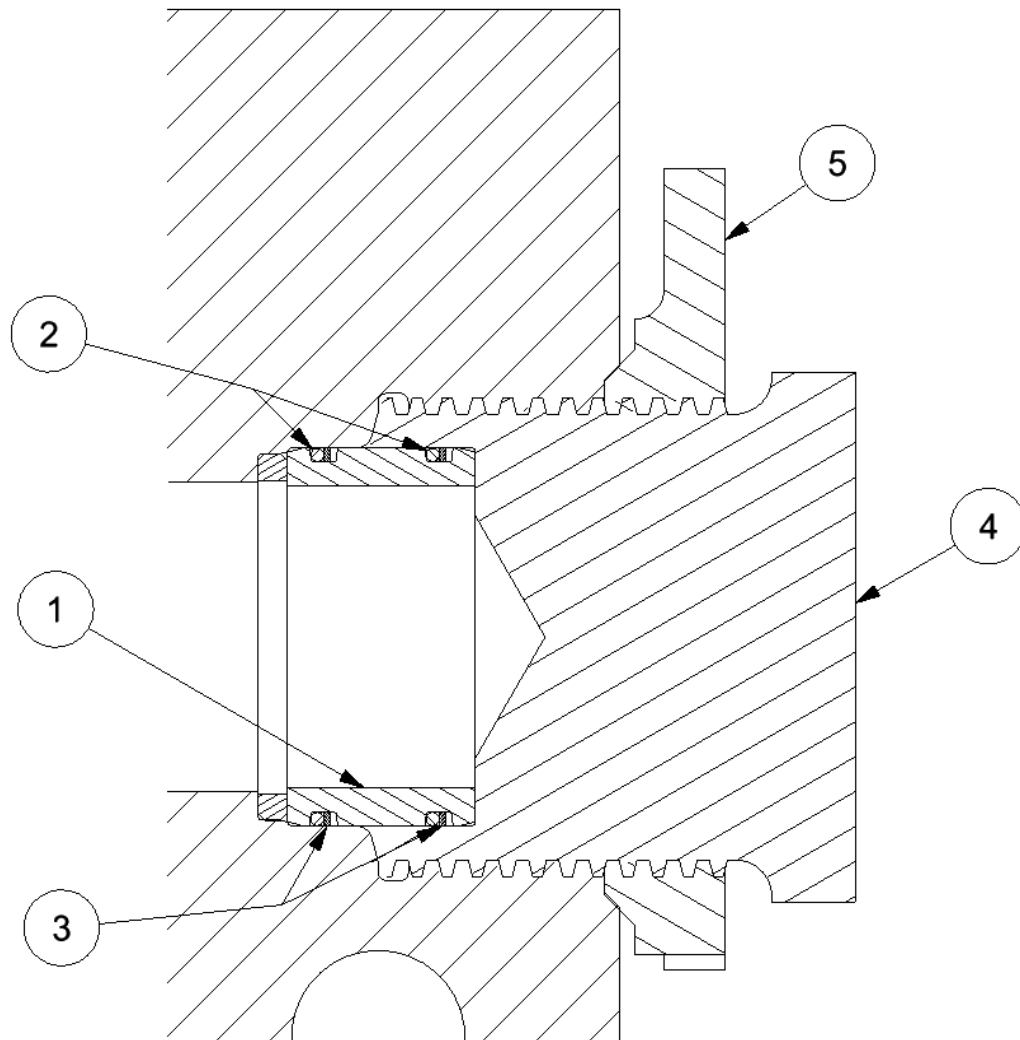

Ref. Drawing  
310FWQ810

**Figure 17: DISCHARGE FLANGE GROUP (BLIND)**

### DISCHARGE FLANGE GROUP (BLIND): 400TWC4038

Ref. No.	Name of Part	Qty.	Part No.
1	BUSHING	1	403400090
2	O-RING	2	169828
3	BACK-UP RING	2	429003000
4	ADAPTER	1	403404090
5	WING NUT	1	403403000

### SUCTION MANIFOLD GROUP

Order by part number and description. Reference numbers are for your convenience only.

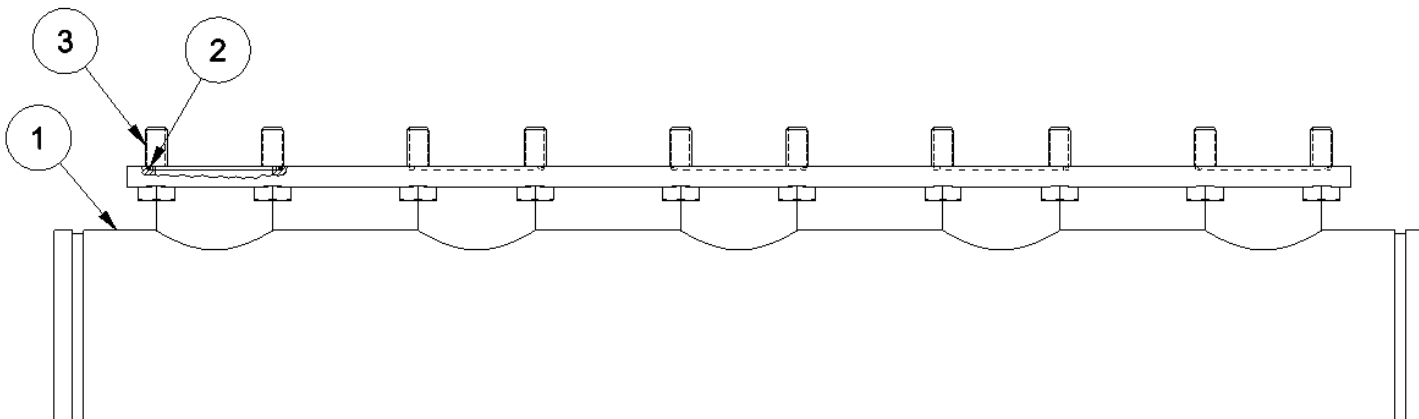

Ref. Drawing  
311FWQ810

**Figure 18: SUCTION MANIFOLD GROUP**

**6" WITH VICTAULIC ENDS: 400FWQ4053**

<b>Ref. No.</b>	<b>Name of Part</b>	<b>Qty.</b>	<b>Part No.</b>
1	SUCTION MANIFOLD	1	PP1037619
2	O-RING	5	161125
3	SCREW	20	103296

## VALVE SEAT PULLER KITS

Order by part number and description. Reference numbers are for your convenience only.

<b>Name of Part</b>	<b>Qty.</b>	<b>Part No.</b>
2.75 – 3” Valve Seat Puller Kit*	1	406THD6031
(*Includes the following 3 items)		
* Seat Puller Jack Assembly	1	PP1013245
* Puller Head Assembly	1	PP1049186
* Tool Box	1	H-400
3.5 – 4.5” Valve Seat Puller Kit*	1	402THD6031
(*Includes the following 3 items)		
* Seat Puller Jack Assembly	1	102014
* Puller Head Assembly	1	PP1049188
* Tool Box	1	H-400

北京

信德迈科技(北京)有限公司CNMEC Technology  
北京朝阳区胜古中路2号金基业大厦201室  
邮编：100029  
电话：010-8428 2935 13910962635  
传真：010-8428 8762  
主页：[//www.cnmec.biz](http://www.cnmec.biz)  
电子邮件：[sales@cnmec.biz](mailto:sales@cnmec.biz)

西安

西安嘉岳自动化技术有限公司Garye Automation  
地址：西安经开区凤城二路天地时代广场B座23层22312室  
邮编：710016  
电话：029 - 8610 8648 15319759129  
传真：029 - 8610 6806  
主页：<http://www.garye.cn>  
电子邮件：[sales@garye.cn](mailto:sales@garye.cn)

For additional information contact your local representative or

Gardner Denver Inc.  
4747 South 83<sup>rd</sup> East Avenue, Tulsa, OK 74145  
PH: (918) 664-1151, (800) 637-8099  
FAX: (918) 664-6225  
[www.gardnerdenver.com](http://www.gardnerdenver.com)

**Gardner**  
**Denver**

Specifications subject to change without notice.  
Copyright © 2005 Gardner Denver, Inc. Litho in U.S.A2